

DEMO NOTES

1. REMOVE ALL BULK MAINS, RISERS, PIPES, SPRINKLER HEADS, AND PIPE HANGERS.
2. CUT AND CAP 6" SPRINKLER MAIN AT A CONVENIENT HEIGHT ABOVE CELL FLOOR.
3. CUT AND CAP 8" SPRINKLER MAIN IN RISER ROOM BELOW FLOOR LEVEL. PATCH FLOOR WITH GROUT TO FLUSH. REMOVE RISER ROOM AND ASSOCIATED EQUIPMENT.
4. RUN NEW VICTAULIC LINE FROM 316/33 NEAR COLUMN R36 TO M30. RUN 6" DOWN TO NEW RISER ON GROUND FLOOR AND TIE INTO SYSTEM 387/29 6" LINE TO CELL FLOOR. SPECIFIC LOCATION OF NEW 6" LINE MAY BE ADJUSTED DUE TO FIELD CONDITIONS.
5. REFER TO TFR-SE-2016-0298 AND TFR-SE-2016-0275 FOR ANY ADDITIONAL MATERIAL TO BE ORDERED.
6. FME CAP ANY CUTS IN ABANDON SYSTEMS.
7. SPRINKLER SYSTEMS SHALL NOT BE REMOVED UNTIL APPROVED BY THE DEPARTMENT OF ENERGY.

A01

NOTE:
FOR DETAILS OF PIPE HANGERS &
GENERAL NOTES SEE SHEET 4-6610.
HANGERS FOR CROSS MAINS ARE
SHOWN ON SPRINKLER PLANS.

* DESIGN MANAGER:
APPROVAL AND DATE:

POOR QUALITY ORIGINAL
BASE DOCUMENT: X-330 SP 4-4614 REVISION 0 CAD OVERLAY

This document has been reviewed and is
UNCLASSIFIED and NOT UCN. This review
does not constitute clearance for public
release.

#192 *DIG. SIG.
Authorized Derivative Classifier Date

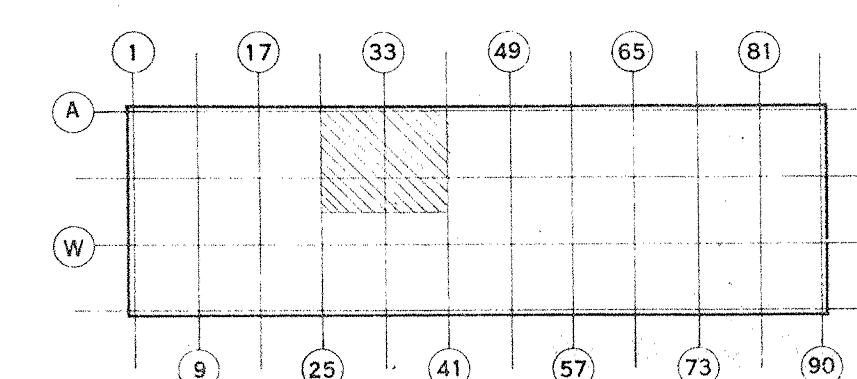

X-330-A-34880		X-330 MATERIAL SIZING AREA DRAWING INDEX, SYMBOLS, REFERENCES, AND ABBREVIATIONS	
SHEET NO.	1	TITLE	REFERENCE DRAWINGS

A01	CFC PER ESO E6663-001	AS BUILT AS REC'D FROM A/E	WAS REV'D	DATED 8-24-58	ISSUE PURPOSE	BY	A.E.C. DATE	OPERATOR	A.E.C. DATE
UNITED STATES ATOMIC ENERGY COMMISSION ARTHUR G. MCKEE & COMPANY INDUSTRIAL ENGINEERING DIVISION-CLEVELAND, OHIO CONTRACT NO. AT-(40-1)-2138									
DRAWING TITLE BULK MAIN AND RISER PLAN SYSTEMS 24,25,28,29,32,35 AND 36									
DRAWING APPROVED-DATE	5-10-58	DRAWING APPROVED-DATE	5-10-58	DRAWING APPROVED-DATE	5-24-58				
ARCHITECT ENGINEER	B. A. OAKLEY	DATE	4/30/58	CHECKED	G. S.	DATE	5/6/58	SCALE	1/16" = 1'-0"
DESIGN	E. R. G.	DATE	4/30/58	APPROVED	W. J. JACKSON	DATE	5/6/58	MC KEE NO.	C-2771
PROJECT	PORTSMOUTH	BUILDING	X-330	SHEET	4-4614	REV	A01		